

Stabilizer Bar Link

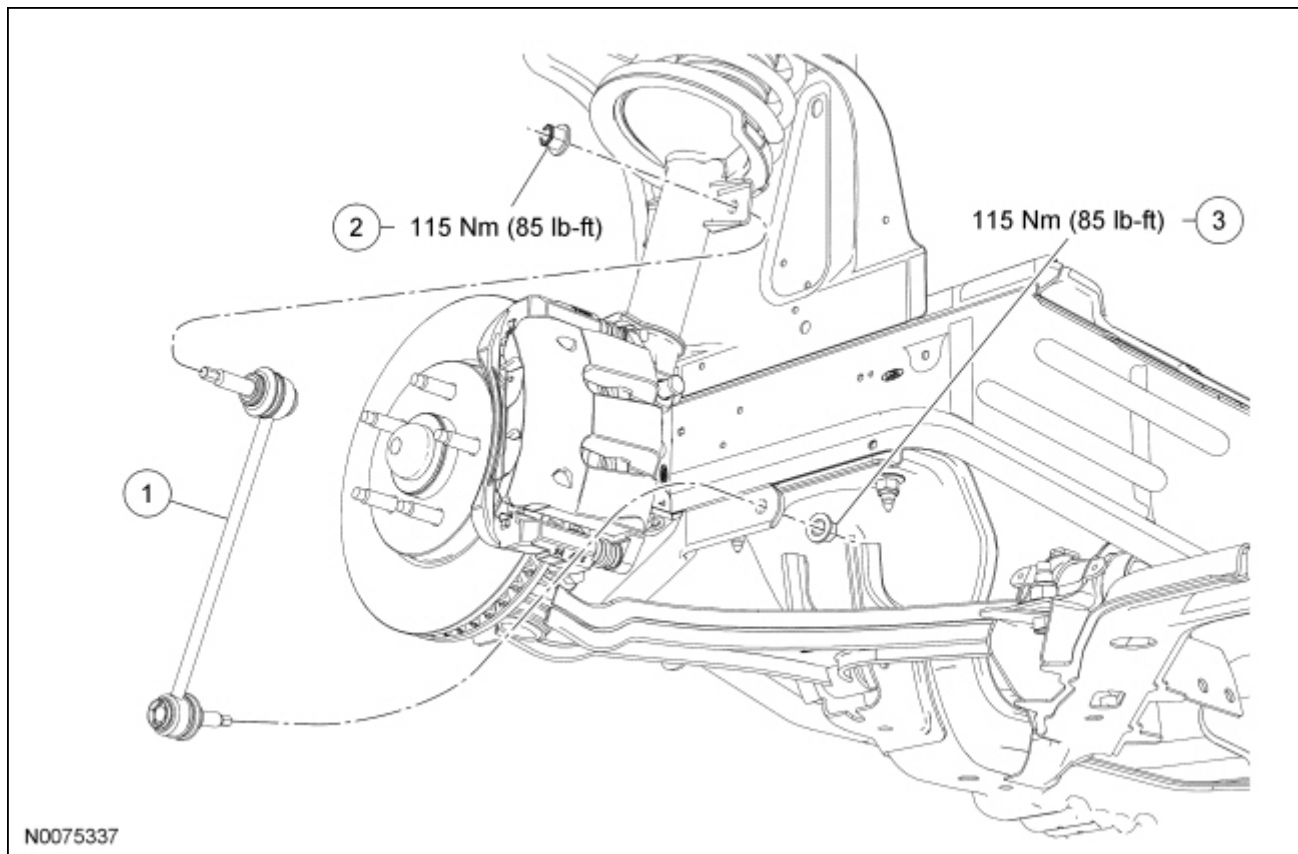

Item	Part Number	Description
1	5K483	Stabilizer bar link
2	W712836	Stabilizer bar link upper nut
3	N807114	Stabilizer bar link lower nut

Removal and Installation

NOTICE: Suspension fasteners are critical parts because they affect performance of vital components and systems and their failure may result in major service expense. New parts must be installed with the same part number or equivalent part, if replacement is necessary. Do not use a replacement part of lesser quality or substitute design. Torque values must be used as specified during reassembly to make sure of correct retention of these parts.

NOTICE: Do not use power tools to remove or install the stabilizer bar link nuts or damage to the link ball joint or boot may occur.

NOTICE: Do not hold the stabilizer bar link boot with any tool, as damage to the boot will occur.

NOTE: Inspect and clean all mating surfaces. Make sure the mating surfaces are free of foreign material. Do not use solvents and/or lubricants. Wipe all surfaces with a clean shop towel.

1. With the vehicle in NEUTRAL, position it on a hoist. For additional information, refer to [Section 100-02](#).

2. **NOTICE: Use the hex-holding feature to prevent the studs from turning while removing or installing the stabilizer bar link nuts. The boot seal must not be allowed to twist at all while tightening the nuts or damage to the boot seal may occur.**

Remove and discard the stabilizer bar link lower nut.

- To install, tighten the new nut to 115 Nm (85 lb-ft).

3. Disconnect the link from the stabilizer bar.

4. **NOTICE: Use the hex-holding feature to prevent the studs from turning while removing or installing the stabilizer bar link nuts. The boot seal must not be allowed to twist at all while tightening the nuts or damage to the boot seal may occur.**

Remove and discard the stabilizer bar link upper nut.

- To install, tighten the new nut to 115 Nm (85 lb-ft).

5. Disconnect the link from the strut.

6. To install, reverse the removal procedure.
-